

PRAVI TERMOELEMENTI S TERMOPAROM Pt10%Rh-Pt - TIP S

1

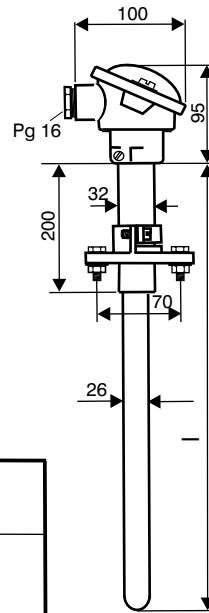

Za uticanje, sa pomičnom prirubnicom
 Prikjučna glava: oblik A (DIN 43729)
 materijal: silumin
 Prirubnica: Temper liv (B TeL.35 / AISi10Mg)
 Priključna pločica: keramička 55 mm

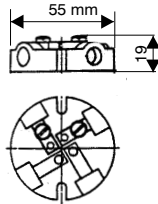

Slika 2.

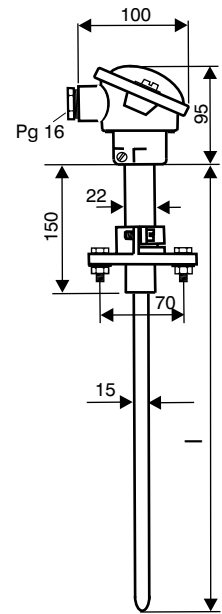

Slika 1.

PREPORUKE ZA IZBOR ZAŠTITNE CEVI:

Materijal zaštitne cevi	Max. temp.	Postojanost
Porculan (KER 610)	1500 C	Za sve gasove bez prisustva kiselih i alkalnih para
Oksidna keramika (KER 710)	1600 C	Za gasove sa alkalnim parama, peći za topljenje stakla i pečenje kreča
Porozna keramika (KER 530)	1600 C	Za sve gasove, uz upotrebu gasonepropusne unutrašnje keramičke cevi. Otporna na temperaturne šokove

Tabela uz sliku 1

Temperatura	Zaštitna cev	Nazivna dužina l (mm)	Kataloški broj					
			Termopar Ø 0,5 mm		Termopar Ø 0,435		Termopar Ø 0,35 mm	
			1 termopar	2 termopara	1 termopar	2 termopara	1 termopar	2 termopara
do 1500°C	Termoelement-porculan (KER 610) Ø 15 x 2 bez unutrašnje cevi	500	42.31.466	42.32.471	42.31.466.1	42.32.471.1	42.31.486	42.32.491
		710	42.31.467	42.32.472	42.31.467.1	42.32.472.1	42.31.487	42.32.492
		1000	42.31.468	42.32.473	42.31.468.1	42.32.473.1	42.31.488	42.32.493
		1400	42.31.469	42.32.474	42.31.469.1	42.32.474.1	42.31.489	42.32.494
do 1500°C	Termoelement-porculan (KER 610) Ø 15 x 2 sa unutrašnjom (KER 610) cev Ø 10 x 1,5	500	42.31.476	42.32.481	42.31.476.1	42.32.481.1	42.31.496	42.32.501
		710	42.31.477	42.32.482	42.31.477.1	42.32.482.1	42.31.497	42.32.502
		1000	42.31.478	42.32.483	42.31.478.1	42.32.483.1	42.31.498	42.32.503
do 1600°C	Oksidna keramika (KER 710) Ø 15 x 2,5 bez unutrašnje cevi	500	42.31.526	42.32.531	42.31.526.1	42.32.531.1	42.31.536	42.32.541
		710	42.31.527	42.32.532	42.31.527.1	42.32.532.1	42.31.537	42.32.542
		1000	42.31.528	42.32.533	42.31.528.1	42.32.533.1	42.31.538	42.32.543

Tabela uz sliku 2

do 1600 C	Porozna keramika (KER 530) Ø 26 x 4 sa unutrašnjom (KER 610) cevi Ø 15 x 2	500	42.31.506	42.32.511	42.31.506.1	42.32.511.1	42.31.516	42.32.521
		710	42.31.507	42.32.512	42.31.507.1	42.32.512.1	42.31.517	42.32.522
		1000	42.31.508	42.32.513	42.31.508.1	42.31.513.1	42.31.518	42.32.523
		1400	42.31.509	42.32.514	42.31.509.1	42.32.514.1	42.31.519	42.32.524